

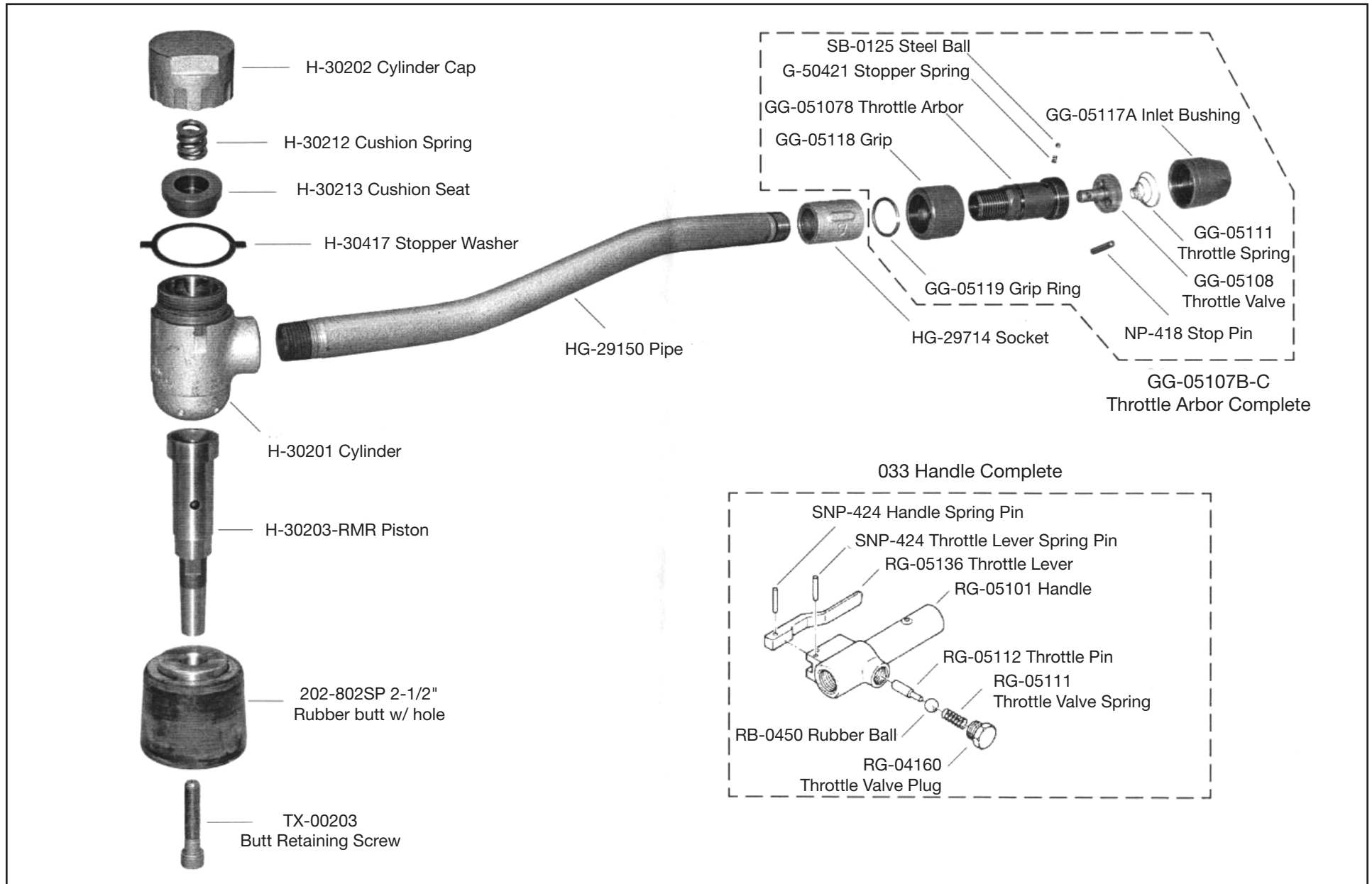

MICHIGAN PNEUMATIC TOOL, INC.

MP-B401MR & MP-B401MRL Corner Rammer



6850 Middlebelt Rd. • Romulus, MI 48174 • 1-800-521-8104 • Ph: (313) 933-5890 • Fax: (313) 933-0440

www.michiganpneumatic.com • e-mail: mpt@michiganpneumatic.com

02132017Rev3CEH | NP



Rubber Rammer Butts

Made of the finest neoprene to ensure uniformity of bonding. Highly resistant to oil and wear. Please specify tool model number and size of butt when ordering. Solid aluminum, steel and rectangular butts available.



201
1-3/4" Dia.



202
2-3/8" Dia.



203
3-1/4" Dia.



204
4" Dia.



205
5" Dia.

802 Taper	
MP-OB, BD2BA, BD1BA	
Master Power 1BA, 2BA	
B&D 5200, 5205	
Cleco OB, 1B, 1F	
TX-70B, TX8-2, TX8-4	

Part No.	Taper
201-802	802

Part No.	Taper
202-802	802

Part No.	Taper
203-802	802

Part No.	Taper
204-802	802

Part No.	Taper
205-802	802

Butt Retaining Screws

Designed to retain 801, 802 and 803 series butts to the piston.



130SR-85



TX-00203

Butt Screw Part No.	Thread	Tool Model
130SR-85	5/16"-18	MP-130
TX-00203	3/8"-24	MP-OB, MP-BD1BA, MP-BD2BA, MP-241

Steel Rammer Butts



200-802
2" Steel
802 Taper



200-802-BS
2" Steel
802 Taper
Screw-Type



300-802
3" Steel
802 Taper



300-802-SP
3" Steel
802 Taper
Screw-Type

Part No.	Taper
200-802	802
300-802	802
300-802-SP	802

Specialty Rammer Butts with Screw Holes

Primarily used on MP-OB, BD2BA and BD1BA Series rammers with butt retainer screw. MPT is the only company that machines our piston to accommodate retainer bolt screws.

Rubber



202
2-3/8" Dia.



203
3-1/4" Dia.

Brass



202-802SP-BR
2-1/2" Dia. Brass

Nylon



202-802SP-NY
2-1/2" Dia. Nylon

Part No.	Taper
202-802SP	802

Part No.	Taper
203-802SP	802

Part No.	Taper
202-802SP-BR	802

Part No.	Taper
202-802SP-NY	802

Aluminum with Rubber Tip Butts



2010
2-3/8" Aluminum
with Rubber Tip



2515
3" Aluminum with
Rubber Tip



3525
3/4" x 2-3/8"
Aluminum with
Rubber Tip



4030
1" x 2-7/8"
Aluminum with
Rubber Tip

Aluminum Rammer Butts



275A-802
2-1/2" Aluminum
802 Taper



2009-SA802
2-1/2" Aluminum
802 Taper

Part No.	Taper
2010-802	802

Part No.	Taper
2515-802	802

Part No.	Taper
3525-802	802

Part No.	Taper
4030-802	802

Part No.	Taper
275A-802	802
2009-SA802	802